

01  
PROPOSED GROUND FLOOR PLAN  
1:50

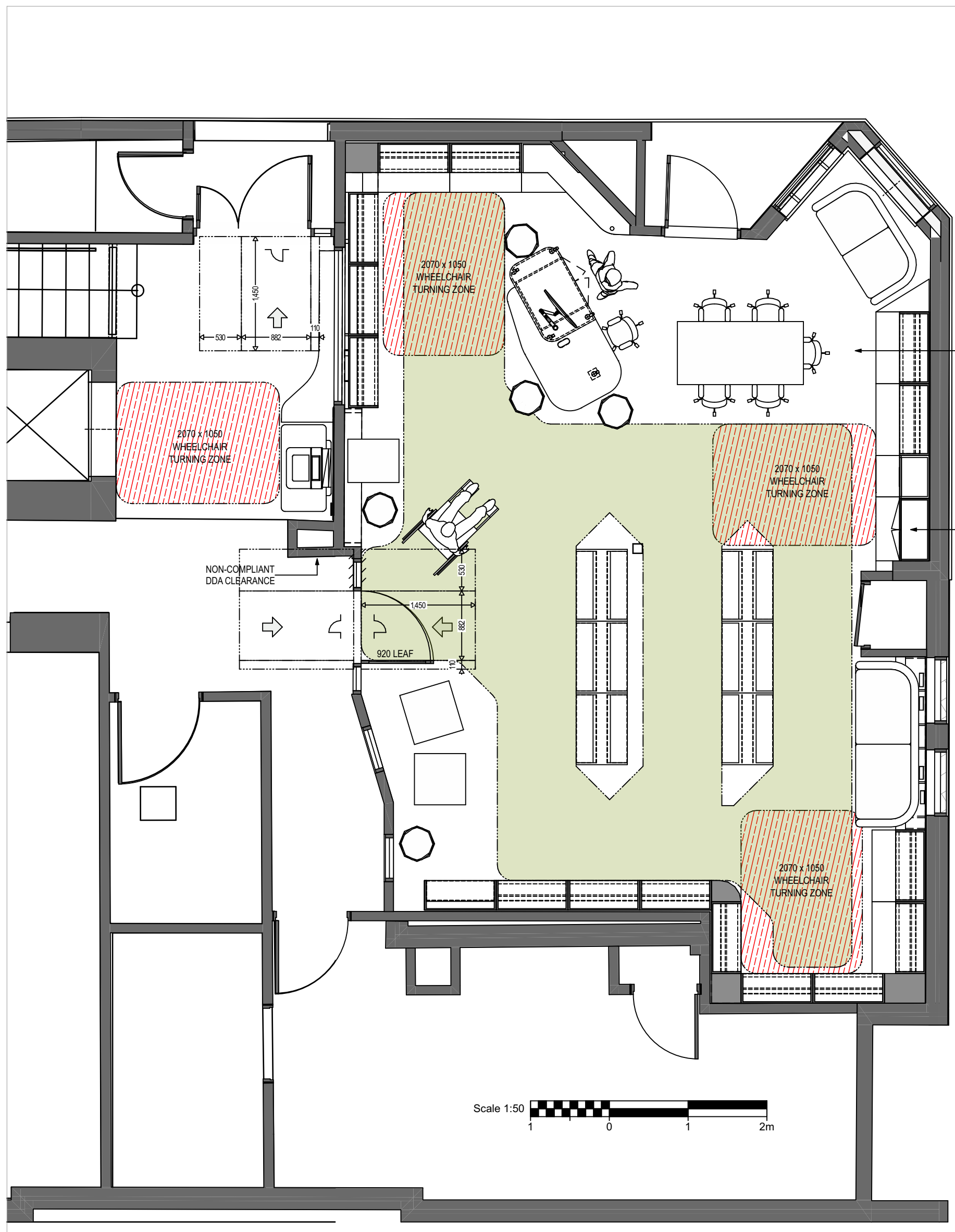

02  
PROPOSED CIRCULATION PLAN  
1:50

#### DDA CIRCULATION KEY (AS1428.1)

- CLEAR CIRCULATION ZONE REQUIRED FOR WHEELCHAIR
- CLEAR TURNING ZONE FOR WHEELCHAIR

#### SHELVING KEY

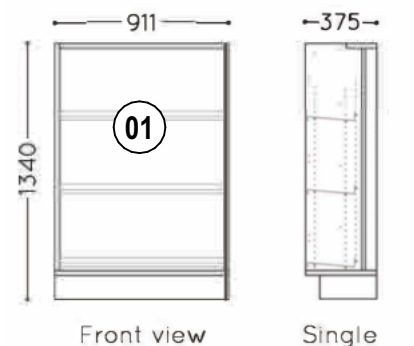

1340mm SHELVING  
CAN BE CONFIGURED 3/4  
SHELVES PER UNIT  
DEPENDENT ON BOOK  
TYPES

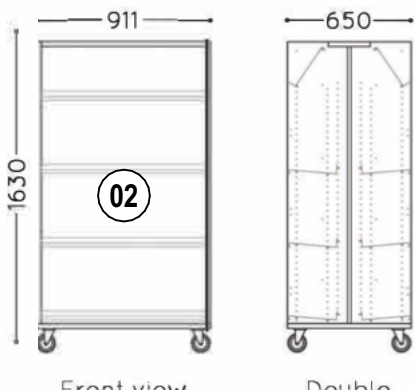

1630mm DOUBLE SHELVING  
ON CASTORS  
CAN BE CONFIGURED 4/5  
SHELVES PER UNIT  
DEPENDENT ON BOOK  
TYPES. MOBILE TO ALLOW  
MOVING TO CATER TO  
LARGER NUMBERS OF  
PEOPLE

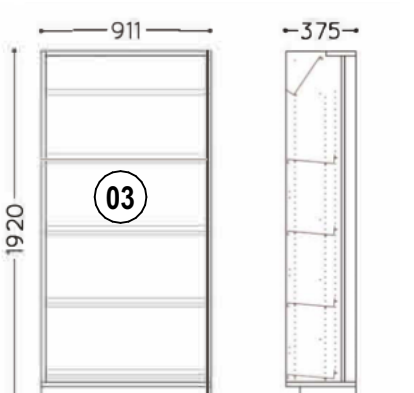

1920mm WALL SHELVING  
CAN BE CONFIGURED 5/6  
SHELVES PER UNIT  
DEPENDENT ON BOOK  
TYPES. MUST BE FIXED TO  
WALL.  
CUSTOM CONSTRUCTION  
WITH BASE (DETAILS TBC)



STAFF POD IS MOBILE FLEXIBLE UNIT. OR CAN  
BE A FIXED ITEM THAT CAN ALSO BE A SIT STAND  
ELEMENT. PENDING FEEDBACK

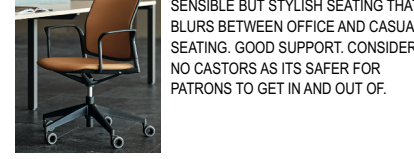
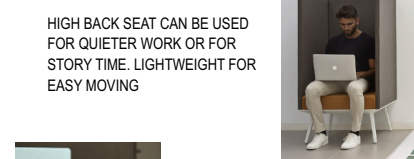
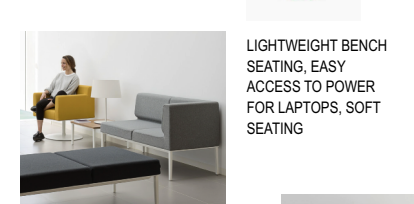

AUTEX OVERVIEW  
AUTEX PARTITION  
AUTEX ACROSS

Autex Acoustic Ceiling Baffles

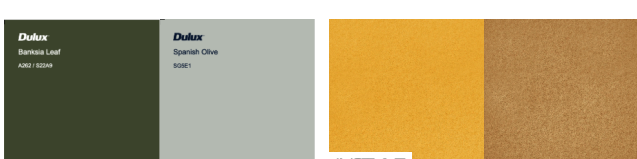
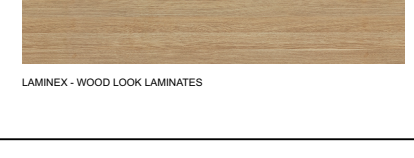

PAINT COLOURS TBC  
FABRIC COLOURS TBC

PAINT COLOURS TBC  
FABRIC COLOURS TBC



Autex Acoustic Ceiling Clouds

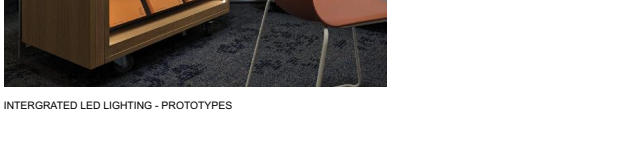
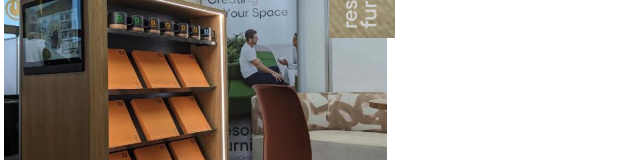
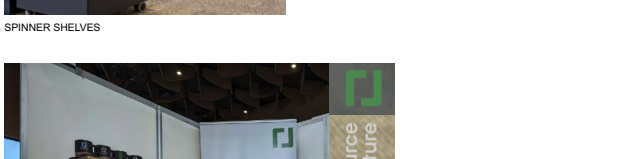
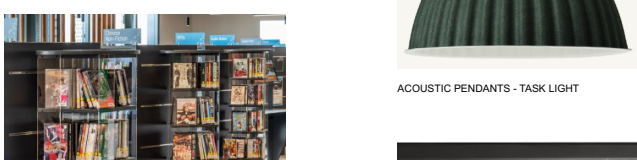

- #### GENERAL NOTES
- UNO ALL DIMENSIONS ARE IN MILLIMETRES. VERIFY ALL DIMENSIONS ON SITE BEFORE COMMENCING ANY WORK OR SHOP DRAWINGS OR ORDERING ANY MATERIALS. DO NOT SCALE DRAWINGS.
  - NOTIFY ANY ERRORS, DISCREPANCIES OR OMISSIONS TO THE ARCHITECT.
  - DRAWINGS SHALL NOT BE USED FOR CONSTRUCTION PURPOSES UNTIL ISSUED FOR CONSTRUCTION.
  - ALL BOUNDARIES, CONTOURS AND LEVELS ARE SUBJECT TO SURVEY

#### A2 PLANS

- REFER TO FULL SPECIFICATION FOR FIXTURES, MATERIALS AND FINISHES CODES.
- GENERALLY NEW SERVICES AND CABLING ARE TO BE CONCEALED WITHIN WALLS, CEILINGS, SKIRTINGS AND FLOORS UNLESS NOTED OTHERWISE.
- THE MAIN CONTRACTOR IS RESPONSIBLE FOR THE COORDINATION LOCATION OF ALL SERVICES AT ALL STAGES OF CONSTRUCTION.
- SET-OUTS SHOWN ARE INDICATIVE. THE CONTRACTOR IS TO DETERMINE THE CORRECT SET-OUT REQUIRED TO ACHIEVE THE REQUIRED LEVELS, FALLS, MINIMUM SCREED BED THICKNESSES AND FLUSH THRESHOLDS THROUGHOUT THE PROJECT AND WITH THE SPECIFIED FLOOR FINISHES. ALLOW TO PROVIDE ADDITIONAL SCREED AND OR LEVELLING COMPOUND AS REQUIRED TO ACHIEVE BUILD-UP TO FINISHED LEVELS. ALLOW FOR HIGH PERFORMANCE SCREEDS TO ACHIEVE MINIMUM THICKNESSES OF 50MM OR LESS AS REQUIRED.

#### WALL TYPES

- #### NOTES REGARDING WALL TYPES
- REFER TO WALL TYPE SCHEDULE.
  - ALSO REFER ELEVATIONS, SECTIONS & DETAILS FOR ANY ADDITIONAL WALL SET-OUTS BESIDES PLAN DIMENSIONS.
  - REFER TO FULL SPECIFICATIONS UNDER FIXTURES, MATERIALS AND FINISHES SCHEDULE FOR APPLIED FINISHES (EG. T11).
  - UNLESS NOTED OTHERWISE THEN ALLOW AND USE 9mm F01 SHEET LINING TO FACE WET AREA WALLS GENERALLY.
  - MULTIPLE WALL TYPES HAVE VARIOUS CONSTRUCTION AT VARIOUS HEIGHTS. REFER TO THE ELEVATIONS & SECTIONS FOR EXTENTS.
  - WALL TYPES ARE INDICATIVE ONLY. ALSO REFER TO DETAILS AND FINISHES SCHEDULES FOR THE EXACT MAKE, UP AND FINISH. FINAL THICKNESS IS SUBJECT TO TOLERANCES. DO NOT EXCEED OR UNDERSIZE IF THE PERFORMANCE IS AFFECTED.
  - ACOUSTIC WALLS ARE TO BE IN ACCORDANCE WITH THE MANUFACTURERS, (JAMES HARDY, CSR, BORAL, GYPROCK OR SIMILAR) SPECIFICATIONS IN ORDER TO ACHIEVE THE REQUIRED 'CERTIFIED' RVP RATING AS ASSOCIATED WITH WALL TYPES. ENSURE INSTALLATION DETAILS TO FRAMING AND FIXING ARE COMPLIANT. REFER TO SPECIFICATION FOR MINIMUM COMPLIANCES.

#### ARCHITECTURAL METALWORK NOTE:

- ALLOW FOR ALL ARCHITECTURAL METALWORK INCLUDING CLIPS, FIXING.

02 - WIP	CONCEPT - UPDATE			Work in Progress
01	CONCEPT			23/10/2024

REV	ISSUE	CHG ID	CHANGE	DATE
project				
MIDDLE PARK LIBRARY				
254-256 RICHARDSON ST				
MIDDLE PARK VIC 3206				

client	
CITY OF PORT PHILLIP	
99A CARLISLE ST	
ST KILDA TOWN HALL	
VIC 3182	

CROXON RAMSAY
architecture / urban design / interior design / project management
25A Mollison Street, Abbotsford VIC 3067
cnr Lt Nicholson Street & Mollison Street
t: 03 9429 1005 www.croxonramsay.com.au

drawing Title:
GA PLANS
PROPOSED GROUND FLOOR

scale: <b>AS NOTED</b>	phase: <b>CONCEPT DESIGN</b>	
date: <b>23/10/2024</b>	status: <b>PRELIMINARY</b>	
project No: <b>2430</b>	drawing No.: <b>A202 02</b>	REV <b>- WIP</b>